

Unvented water heaters

Pioneers, innovators and market leaders in efficient unvented water heating

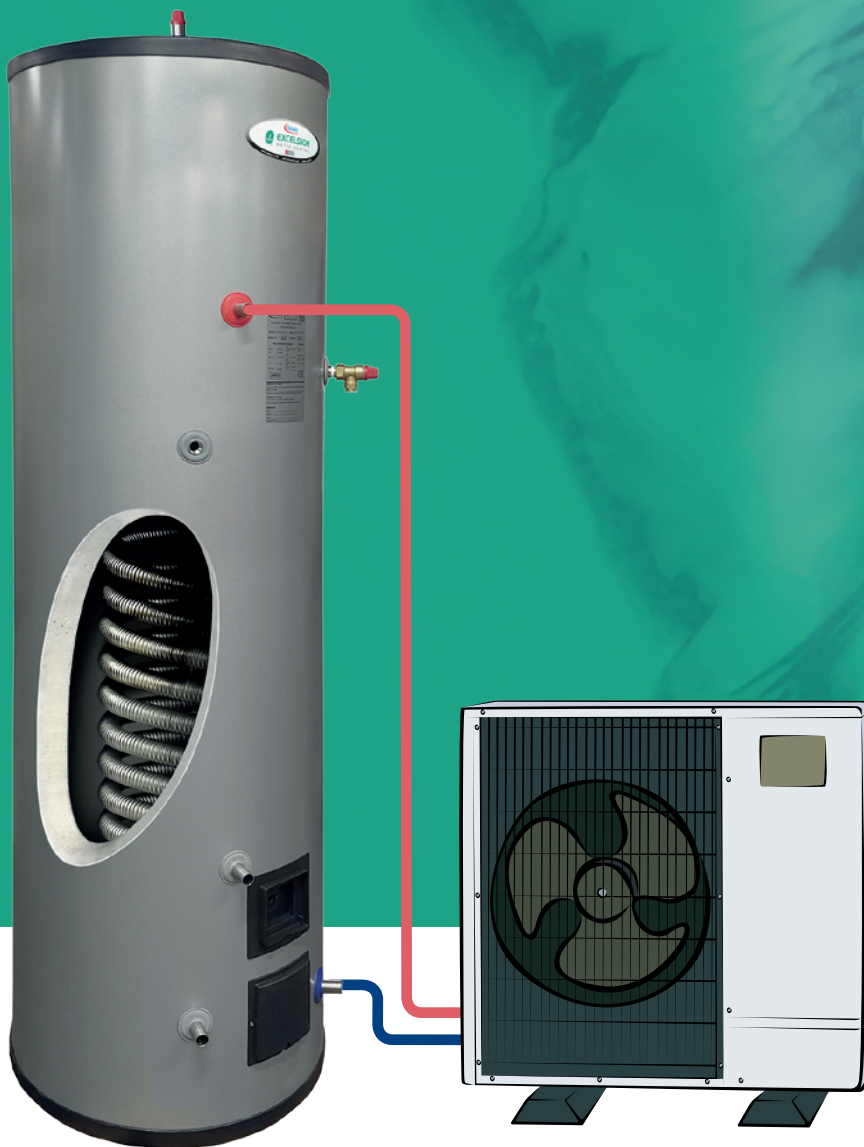

Designed and manufactured in the UK



Excelsior

Specification guide

Product construction - typical

| | |
|----------------------------|---|
| Immersion heater | ☞ 3kw, 240V, 1ph, Incoloy 825, with thermostat incl. cut-out |
| Thermal insulation | ☞ CFC/HCFC free, (ODP=0, GWP=1), 60mm fire retardant insulation* |
| Outer casing | ☞ P200 Platisol |
| Inner cylinder | ☞ Duplex stainless steel |
| Heating coil | ☞ High performance, finned |
| Indirect thermostat | ☞ Twin thermostat with independent reset, 30-70°C |
| Safety device | ☞ Factory fitted with 7bar/90°C pressure & temperature relief valve |
| Connections | ☞ Secondary return on 175L & above |

* 50mm on 400L and 500L vessels



Product specification

| | |
|----------------------------------|--|
| Inlet diffuser | ☞ For optimal blending of cold & hot water, see fig. 1 |
| Expansion | ☞ WXI - 3 bar internal expansion with  the self-sustaining air-gap system <i>All other ranges - 3 bar external expansion</i> |
| Pressure test | ☞ Tested to 10 bar |
| Secondary return | ☞ Standard fit on models 175L & above |
| Approvals | ☞ BBA, CE, WRAS, KIWA, ISO, WRC |
| Guarantee | ☞ Internal cylinder 25 years* Ancillary components 1 year |
| Direct thermostat | ☞ Element thermostat, nominal setting 60°C |
| Indirect model | ☞ 22mm diameter stainless steel high performance coil & outlet with 1 immersion heater |
| Direct model | ☞ 80L fitted with 1 immersion heater; 130 - 500L fitted with 2 immersion heaters |
| Manufacturing | ☞ All UK using state-of-the-art robot technology |
| Horizontal & Slimline | ☞ Suitable for roof voids & 450mmØ specification |
| Renewables range | ☞ Solar, heat pump and buffer vessels |

* Commercial cylinders carry 5 years guarantee

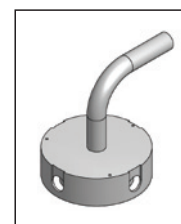



Fig.1

Features & Benefits

| Specifier/builder features | Installer benefits | Consumer benefits |
|--|-----------------------------------|---|
| 1 Duplex stainless steel | No sacrificial anode | Low maintenance |
| 2 UK designed & manufactured | Local support | Spares and service back up |
| 3 Butt welded joints | Eliminates corrosion | Long cylinder life |
| 4 Inlet diffuser | Maximises hot water | Maximises hot water |
| 5 High performance heating coil | Fast re-heat times | Constant hot water |
| 6 Minimal heat loss | 60mm insulation with outer casing | Lower energy use |
| 7 High flow rates | No shower pumps | Fast filling baths |
| 8 Balanced hot & cold water | Mains pressure to all outlets | High performance showering |
| 9 Pre-plumbed available | Ease of installation | Minimal disruption |
| 10 Twin or triple coil available | Suits all heat sources | Useable with solar or heat pumps |
| 11 Excelsior with  | Reduces installation time | Maintenance-free |
| 12 Hi-Flo Excelsior with  | Suits large domestic/commercial | Higher flow rates with 'Venturi' Technology |

Excelsior

Heating performance

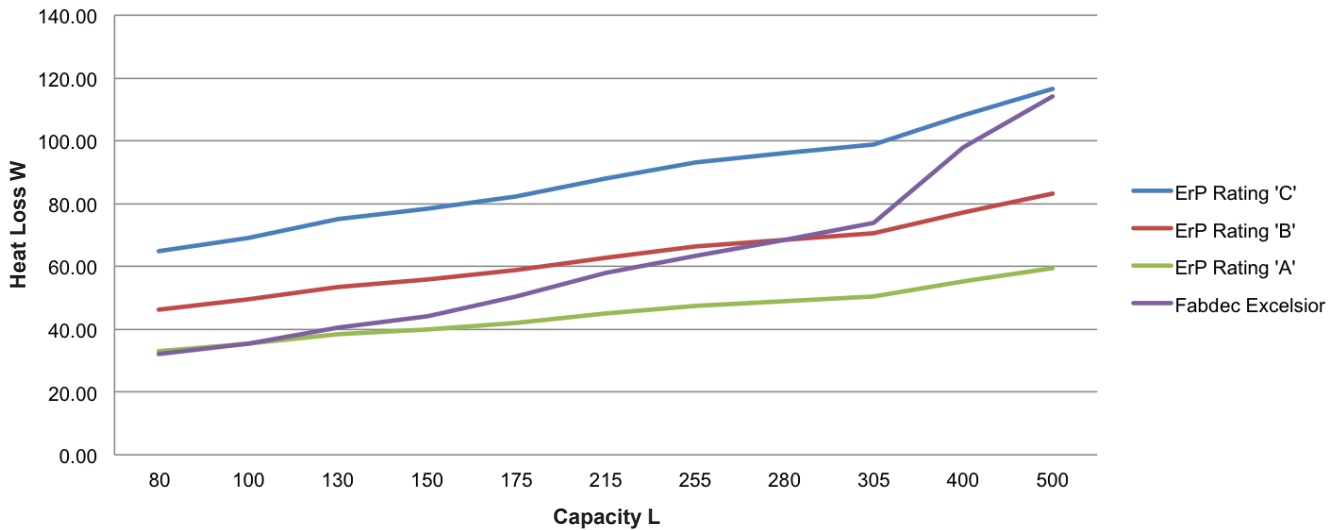

| Vessel | Direct | | | Indirect | | Coils (kW) | | Weight (kg) | | Weight (kg) Full | |
|--------|-----------------------------|---------------------------------|---------------------------------|---------------------------------|---------------------------------|------------|--------|-------------|--------|------------------|--|
| | Standing Heat Loss (kW/24h) | Reheat time after 70% draw off* | Time to heat from cold to 65°C* | Reheat time after 70% draw off* | Time to heat from cold to 65°C* | Primary | Direct | Indirect | Direct | Indirect | |
| 80L | 0.77 | 71 | 102 | 15 | 21 | 14.6 | 25 | 30 | 105 | 110 | |
| 100L | 0.85 | 80 | 110 | 17 | 24 | 14.6 | 27 | 32 | 127 | 132 | |
| 130L | 0.97 | 83 | 115 | 20 | 27 | 14.6 | 30 | 35 | 160 | 165 | |
| 150L | 1.06 | 109 | 123 | 22 | 31 | 14.6 | 35 | 40 | 185 | 190 | |
| 175L | 1.21 | 131 | 148 | 21 | 31 | 20 | 40 | 45 | 215 | 220 | |
| 215L | 1.39 | 157 | 182 | 26 | 37 | 20 | 45 | 50 | 260 | 265 | |
| 255L | 1.52 | 191 | 229 | 29 | 42 | 20 | 50 | 55 | 305 | 310 | |
| 280L | 1.64 | 210 | 245 | 32 | 44 | 20 | 53 | 58 | 333 | 338 | |
| 305L | 1.77 | 228 | 261 | 34 | 46 | 20 | 55 | 60 | 360 | 365 | |
| 400L | 2.35 | 220 | 340 | 40 | 57 | 27 | 65 | 68 | 465 | 468 | |
| 500L | 2.74 | 326 | 425 | 55 | 71 | 27 | 75 | 78 | 575 | 578 | |

* Time (minutes)

| ** Vessel | Solar Direct | | | Solar Indirect | | Coils (kW) | | Weight (kg) | | Weight (kg) Full | |
|-----------|-----------------------------|---------------------------------|---------------------------------|---------------------------------|---------------------------------|-------------------|---------|--------------|----------------|------------------|----------------|
| | Standing Heat Loss (kW/24h) | Reheat time after 70% draw off* | Time to heat from cold to 65°C* | Reheat time after 70% draw off* | Time to heat from cold to 65°C* | Aux / Boiler Coil | Primary | Solar Direct | Solar Indirect | Solar Direct | Solar Indirect |
| 130L | - | 16 | 20 | - | - | 14.6 | 20 | 35 | 40 | 165 | 170 |
| 150L | - | 19 | 23 | - | - | 14.6 | 20 | 40 | 45 | 190 | 195 |
| 175L | - | 14 | 20 | 14 | 20 | 20 | 27 | 45 | 50 | 220 | 225 |
| 215L | - | 17 | 24 | 17 | 24 | 20 | 27 | 50 | 55 | 265 | 270 |
| 255L | - | 20 | 29 | 20 | 29 | 20 | 27 | 55 | 60 | 310 | 315 |
| 305L | - | 24 | 34 | 24 | 34 | 20 | 27 | 60 | 65 | 365 | 370 |

* Time (minutes)

Excelsior WXI

Excelsior with  **VENTURI**
TECHNOLOGY

Current issues with expansion in unvented water heaters:

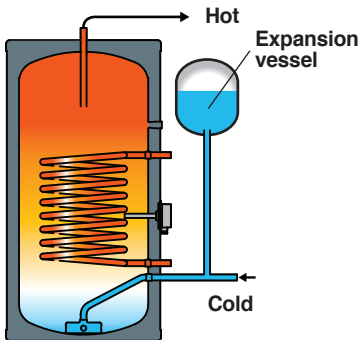

External expansion

- ✗ Bulky, has more parts, requires more space
- ✗ Requires longer on-site installation
- ✗ Needs replenishment

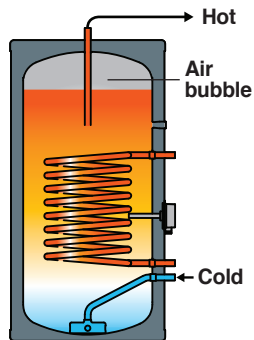

Internal expansion

- ✗ Integrated air bubble
- ✗ Needs frequent replenishment
- ✗ Takes only low pressure

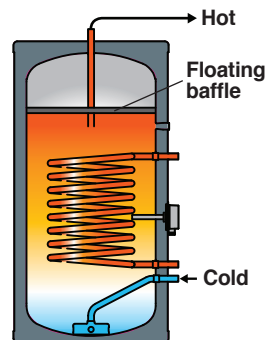

Protected Internal expansion

- ✗ Integrated air bubble
- ✗ Protected with a plastic baffle
- ✗ Could need replenishment as baffle seal is not fully 100%

How Venturi technology works:

Water drawn from the mains flows through a patented special inlet device using fluid dynamics to create negative pressure known as the 'Venturi effect'. With precision design this configuration draws enough air to recharge the air gap as the tank is filled and requires minimal ongoing maintenance.

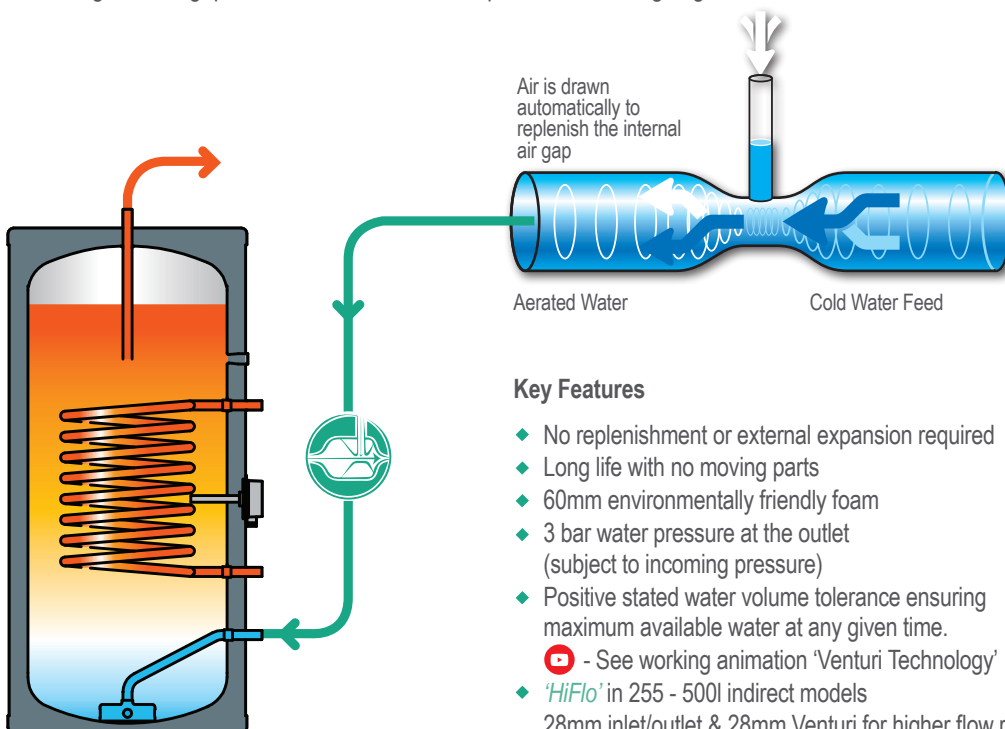

Key Features

- ◆ No replenishment or external expansion required
- ◆ Long life with no moving parts
- ◆ 60mm environmentally friendly foam
- ◆ 3 bar water pressure at the outlet (subject to incoming pressure)
- ◆ Positive stated water volume tolerance ensuring maximum available water at any given time.
- ◆  - See working animation 'Venturi Technology'
- ◆ 'HiFlo' in 255 - 500l indirect models
- ◆ 28mm inlet/outlet & 28mm Venturi for higher flow rates

Excelsior WXI & WXI HiFLO

Excelsior with  **VENTURI**
TECHNOLOGY

| Direct with internal expansion | | | | | | | |
|--------------------------------|------|-----|-----|-----|-----|-----|-----|
| Size | H | D | I | O | T | IH1 | IH2 |
| 80L | 703 | 576 | 182 | * | 222 | 196 | - |
| 100L | 860 | 576 | 182 | * | 318 | 196 | 457 |
| 130L | 1043 | 576 | 182 | 221 | 331 | 196 | 540 |
| 150L | 1235 | 576 | 182 | 285 | 395 | 196 | 613 |
| 175L | 1370 | 576 | 182 | 397 | 507 | 196 | 673 |
| 215L | 1666 | 576 | 182 | 440 | 550 | 196 | 754 |
| 255L | 1884 | 576 | 182 | 440 | 550 | 196 | 780 |
| 280L | 2028 | 576 | 182 | 478 | 588 | 196 | 875 |
| 300L | 2150 | 576 | 182 | 450 | 560 | 196 | 847 |
| 400L | 1522 | 756 | 220 | 350 | 460 | 235 | 657 |
| 500L | 1896 | 756 | 220 | 385 | 495 | 235 | 891 |

* Outlet on top of vessel for 80l and 100l models

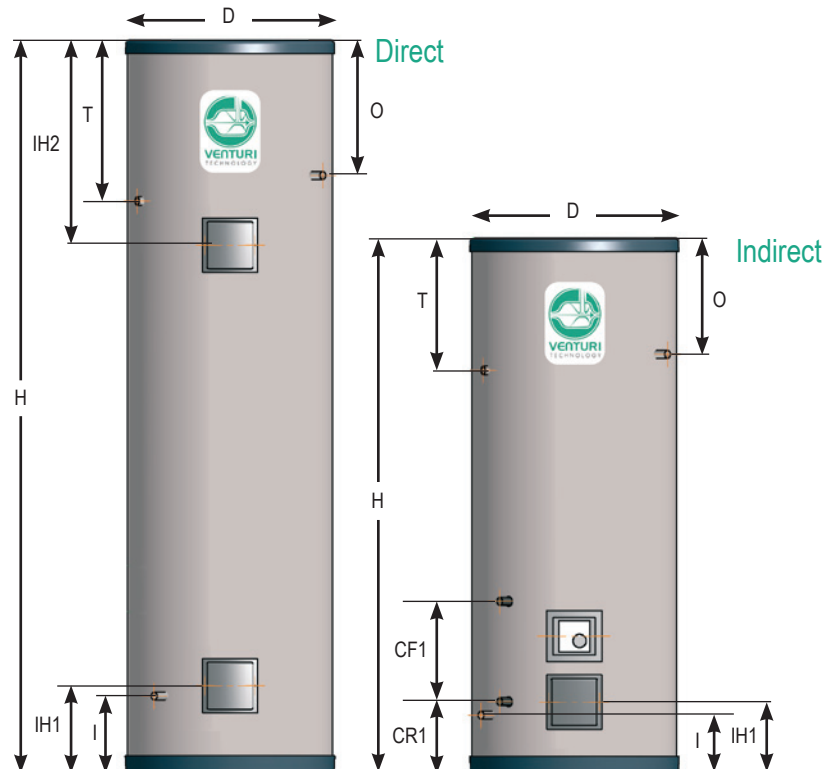

| Indirect with internal expansion | | | | | | | | | |
|----------------------------------|------|-----|-----|-----|-----|-----|-----|-----|-------------|
| Size | H | D | I | O | T | IH1 | CR1 | CF1 | Coil Rating |
| 80L | 703 | 576 | 182 | * | 222 | 196 | 213 | 88 | 14.6kW |
| 100L | 860 | 576 | 182 | * | 318 | 196 | 213 | 88 | 14.6kW |
| 130L | 1043 | 576 | 182 | 221 | 331 | 196 | 213 | 193 | 14.6kW |
| 150L | 1235 | 576 | 182 | 285 | 395 | 196 | 213 | 193 | 14.6kW |
| 175L | 1370 | 576 | 182 | 397 | 507 | 196 | 213 | 263 | 20.0kW |
| 215L | 1666 | 576 | 182 | 440 | 550 | 196 | 213 | 263 | 20.0kW |
| 255L | 1884 | 576 | 182 | 440 | 550 | 196 | 213 | 263 | 20.0kW |
| 280L | 2028 | 576 | 182 | 478 | 588 | 196 | 213 | 263 | 20.0kW |
| 300L | 2150 | 576 | 182 | 450 | 560 | 196 | 213 | 263 | 20.0kW |
| 400L | 1522 | 756 | 220 | 350 | 460 | 235 | 250 | 250 | 27.0kW |
| 500L | 1896 | 756 | 220 | 385 | 495 | 235 | 250 | 250 | 27.0kW |

* Outlet on top of vessel for 80l and 100l models

NEW - Indirect with internal expansion with 28mm diameter stainless steel inlet & outlet

| Size | H | D | I | O | T | IH1 | CR1 | CF1 | Coil Rating |
|------|------|-----|-----|-----|-----|-----|-----|-----|-------------|
| 255L | 1884 | 576 | 182 | 440 | 550 | 196 | 213 | 263 | 20.0kW |
| 280L | 2028 | 576 | 182 | 478 | 588 | 196 | 213 | 263 | 20.0kW |
| 300L | 2150 | 576 | 182 | 450 | 560 | 196 | 213 | 263 | 20.0kW |
| 400L | 1522 | 756 | 220 | 350 | 460 | 235 | 250 | 250 | 27.0kW |
| 500L | 1896 | 756 | 220 | 385 | 495 | 235 | 250 | 250 | 27.0kW |



Excelsior WXIS

Solar range with internal expansion

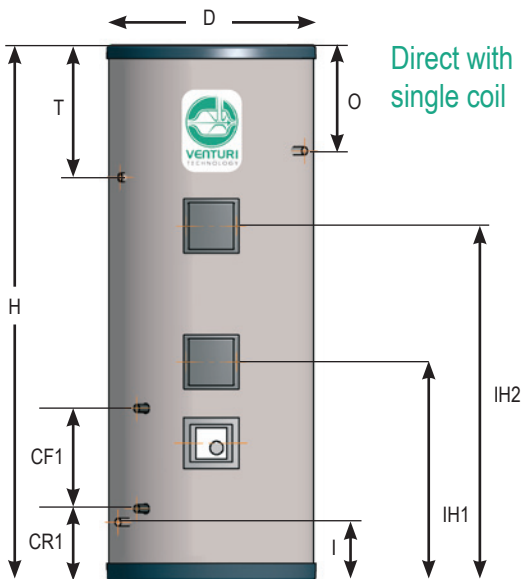

Direct with single coil

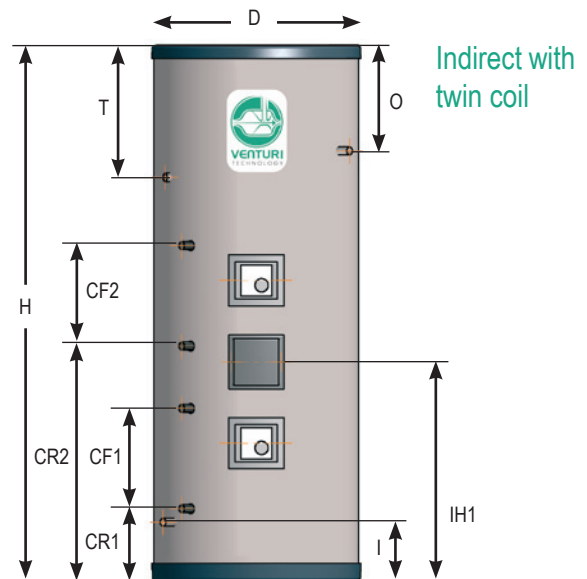

Indirect with twin coil

Solar Direct with single coil

| Size | H | D | I | O | T | IH1 | CR1 | CF1 | Solar Coil Surface Area |
|------|------|-----|-----|-----|-----|-----|-----|-----|-------------------------|
| 130L | 1043 | 576 | 182 | 221 | 331 | 454 | 212 | 192 | 0.75m ² |
| 150L | 1235 | 576 | 182 | 285 | 395 | 454 | 212 | 192 | 0.75m ² |
| 175L | 1370 | 576 | 182 | 397 | 507 | 580 | 212 | 262 | 1.1m ² |
| 215L | 1666 | 576 | 182 | 440 | 550 | 524 | 212 | 262 | 1.1m ² |
| 255L | 1884 | 576 | 182 | 440 | 550 | 524 | 212 | 262 | 1.1m ² |
| 300L | 2150 | 576 | 182 | 450 | 560 | 524 | 212 | 262 | 1.1m ² |
| 400L | 1522 | 756 | 220 | 350 | 460 | 538 | 250 | 210 | 1.1m ² |
| 500L | 1896 | 756 | 220 | 385 | 495 | 538 | 250 | 210 | 1.1m ² |

Solar Indirect with twin coil

| CR2 | CF2 | Aux Coil Surface Area |
|-----|-----|-----------------------|
| 504 | 192 | 0.54m ² |
| 504 | 192 | 0.54m ² |
| 574 | 262 | 0.75m ² |
| 574 | 262 | 0.75m ² |
| 574 | 262 | 0.75m ² |
| 574 | 262 | 0.75m ² |
| 560 | 175 | 0.75m ² |
| 560 | 175 | 0.75m ² |

Excelsior WHPXI

Heat Pump range with internal expansion

Heat Pump Direct with single coil

| Size | H | D | I | O | T | IH1 | CR1 | CF1 | Heat Pump Coil Surface Area |
|------|------|-----|-----|-----|-----|-----|-----|------|-----------------------------|
| 215L | 1666 | 576 | 182 | 440 | 550 | 284 | 182 | 765 | 2.0m ² |
| 255L | 1884 | 576 | 182 | 440 | 550 | 284 | 182 | 900 | 2.5m ² |
| 280L | 2028 | 576 | 182 | 478 | 588 | 284 | 182 | 1035 | 3.0m ² |
| 300L | 2150 | 576 | 182 | 450 | 560 | 284 | 182 | 1035 | 3.0m ² |
| 400L | 1522 | 756 | 303 | 350 | 460 | 228 | 303 | 495 | 4.0m ² |
| 500L | 1896 | 756 | 303 | 385 | 495 | 228 | 303 | 495 | 4.0m ² |

Heat Pump Indirect with twin coil

| CR2 | CF2 | Coil Surface Areas | |
|-----|-----|--------------------|-------------------|
| | | Lower | Upper |
| 584 | 495 | 1.1m ² | 1.5m ² |
| 602 | 675 | 1.1m ² | 2.0m ² |
| 652 | 675 | 1.1m ² | 2.0m ² |
| 752 | 675 | 1.1m ² | 2.0m ² |
| - | - | - | - |
| - | - | - | - |

Excelsior WDE

With external expansion

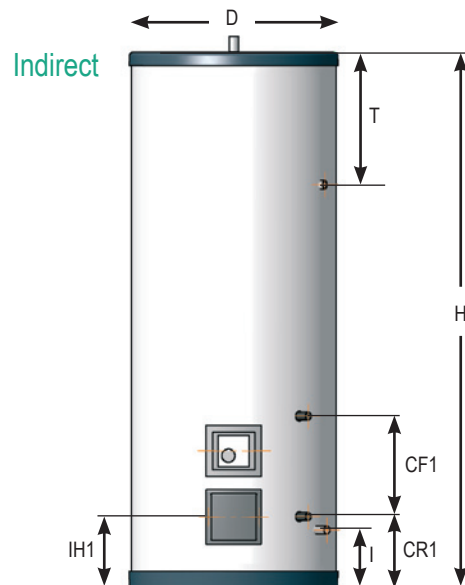
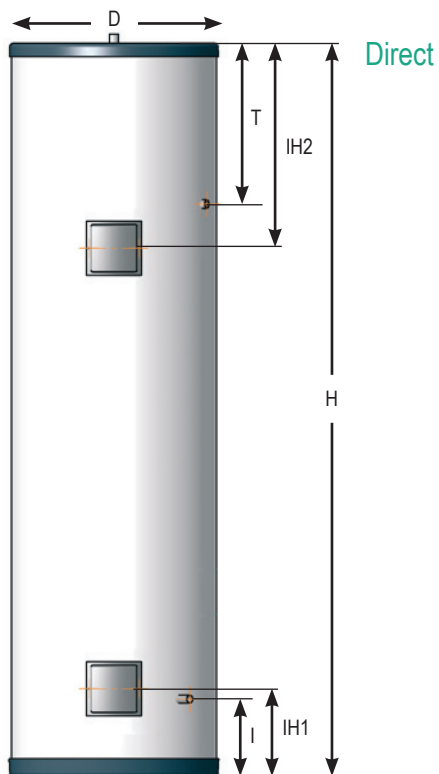

Direct with 3 bar external expansion

| Size | H | D | I | T | IH1 | IH2 |
|------|------|-----|-----|-----|-----|-----|
| 80L | 665 | 576 | 182 | 222 | 196 | N/A |
| 130L | 957 | 576 | 182 | 222 | 196 | 454 |
| 150L | 1085 | 576 | 182 | 222 | 196 | 463 |
| 175L | 1242 | 576 | 182 | 222 | 196 | 545 |
| 215L | 1484 | 576 | 182 | 222 | 196 | 572 |
| 255L | 1752 | 576 | 182 | 222 | 196 | 648 |
| 305L | 2028 | 576 | 182 | 222 | 196 | 725 |
| 400L | 1405 | 756 | 220 | 262 | 235 | 515 |
| 500L | 1690 | 756 | 220 | 262 | 235 | 660 |

Indirect with 3 bar external expansion

| Size | H | D | I | T | IH1 | CR1 | CF1 | Coil Rating |
|------|------|-----|-----|-----|-----|-----|-----|-------------|
| 80L | 665 | 576 | 182 | 222 | 196 | 213 | 88 | 14.6kW |
| 130L | 957 | 576 | 182 | 222 | 196 | 213 | 193 | 14.6kW |
| 150L | 1085 | 576 | 182 | 222 | 196 | 213 | 193 | 14.6kW |
| 175L | 1242 | 576 | 182 | 222 | 196 | 213 | 263 | 20.0kW |
| 215L | 1484 | 576 | 182 | 222 | 196 | 213 | 263 | 20.0kW |
| 255L | 1752 | 576 | 182 | 222 | 196 | 213 | 263 | 20.0kW |
| 305L | 2028 | 576 | 182 | 222 | 196 | 213 | 263 | 20.0kW |
| 400L | 1405 | 756 | 220 | 262 | 235 | 250 | 245 | 27.0kW |
| 500L | 1690 | 756 | 220 | 262 | 235 | 250 | 245 | 27.0kW |

Excelsior WS

Solar range

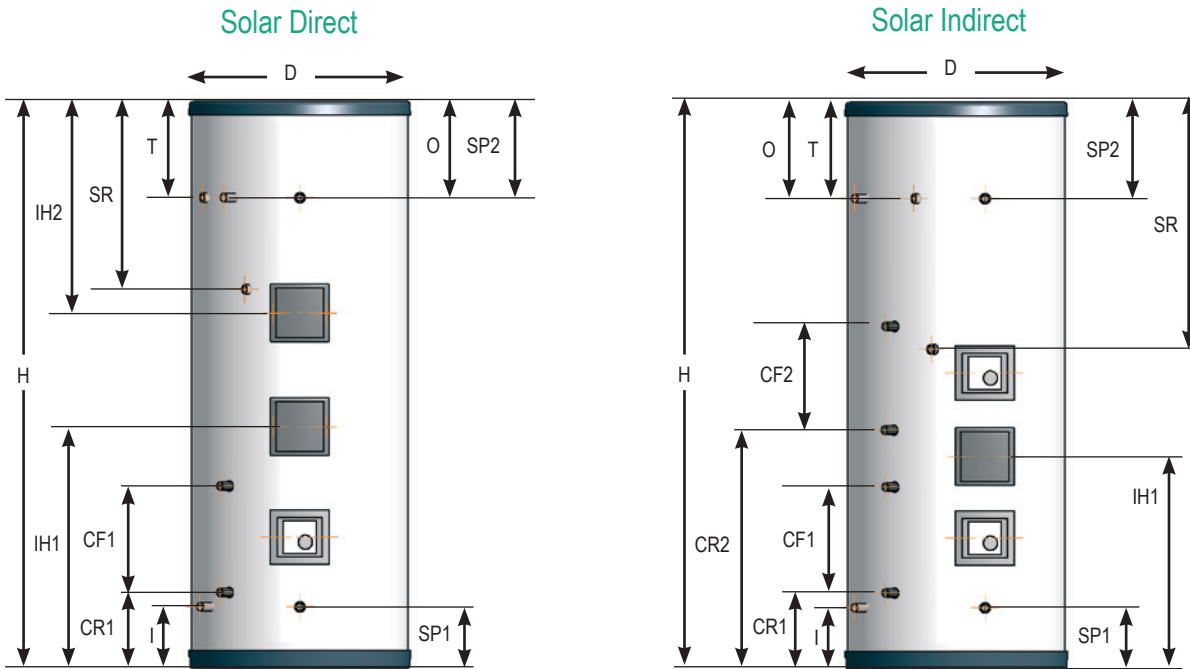

Solar Direct with external expansion

| Size | H | D | I | O | T | CR1 | CF1 | SP1 | IH1 | SR | IH2 | SP2 | Solar Coil Surface Area* | Solar Volume |
|------|------|-----|-----|-----|-----|-----|-----|-----|-----|-----|-----|-----|--------------------------|--------------|
| 130L | 958 | 578 | 183 | 226 | 226 | 213 | 193 | 183 | 454 | 325 | 349 | 226 | 0.75m ² | 56L |
| 150L | 1086 | 578 | 183 | 226 | 226 | 213 | 193 | 183 | 509 | 340 | 402 | 226 | 0.75m ² | 56L |
| 175L | 1243 | 578 | 183 | 226 | 226 | 213 | 267 | 183 | 584 | 473 | 402 | 226 | 1.1m ² | 69L |
| 215L | 1485 | 578 | 183 | 226 | 226 | 213 | 267 | 183 | 587 | 665 | 476 | 226 | 1.1m ² | 69L |
| 255L | 1753 | 578 | 183 | 226 | 226 | 213 | 267 | 183 | 587 | 665 | 476 | 226 | 1.1m ² | 69L |
| 305L | 2029 | 578 | 183 | 226 | 226 | 213 | 267 | 183 | 587 | 665 | 476 | 226 | 1.1m ² | 69L |
| 400L | 1405 | 755 | 220 | 260 | 260 | 250 | 210 | 220 | 538 | 615 | 425 | 260 | 1.1m ² | 69L |
| 500L | 1690 | 755 | 220 | 260 | 260 | 250 | 210 | 220 | 538 | 615 | 425 | 260 | 1.1m ² | 69L |

Solar Indirect with external expansion

| Size | H | D | I | O | T | CR1 | CF1 | SP1 | CR2 | CF2 | IH1 | SR | SP2 | Solar Coil Surface Area* | Aux Coil Surface Area* | Aux Coil Rating | Solar Volume |
|------|------|-----|-----|-----|-----|-----|-----|-----|-----|-----|-----|-----|-----|--------------------------|------------------------|-----------------|--------------|
| 130L | 958 | 578 | 183 | 226 | 226 | 213 | 193 | 183 | 504 | 193 | 454 | 325 | 226 | 0.75m ² | 0.54m ² | 14.6kW | 56L |
| 150L | 1086 | 578 | 183 | 226 | 226 | 213 | 193 | 183 | 504 | 193 | 454 | 340 | 226 | 0.75m ² | 0.54m ² | 14.6kW | 56L |
| 175L | 1243 | 578 | 183 | 226 | 226 | 213 | 267 | 183 | 578 | 263 | 530 | 473 | 226 | 1.1m ² | 0.75m ² | 20.0kW | 69L |
| 215L | 1485 | 578 | 183 | 226 | 226 | 213 | 267 | 183 | 582 | 263 | 530 | 591 | 226 | 1.1m ² | 0.75m ² | 20.0kW | 69L |
| 255L | 1753 | 578 | 183 | 226 | 226 | 213 | 267 | 183 | 582 | 263 | 530 | 665 | 226 | 1.1m ² | 0.75m ² | 20.0kW | 69L |
| 305L | 2029 | 578 | 183 | 226 | 226 | 213 | 267 | 183 | 582 | 263 | 530 | 665 | 226 | 1.1m ² | 0.75m ² | 20.0kW | 69L |
| 400L | 1405 | 755 | 220 | 260 | 260 | 250 | 210 | 220 | 560 | 175 | 510 | 470 | 260 | 1.1m ² | 0.75m ² | 20.0kW | 69L |
| 500L | 1690 | 755 | 220 | 260 | 260 | 250 | 210 | 220 | 560 | 175 | 510 | 543 | 260 | 1.1m ² | 0.75m ² | 20.0kW | 69L |

Excelsior WT

Slimline Direct / Indirect range

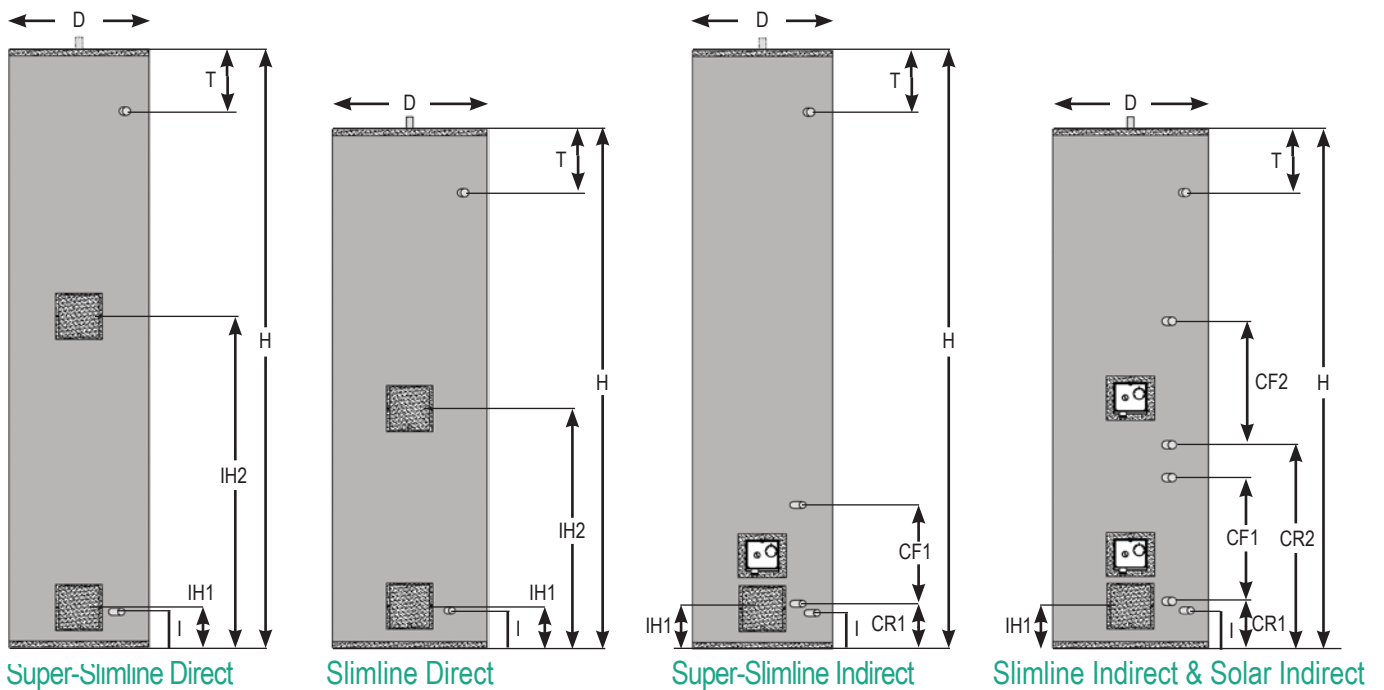

| Slimline Direct with external expansion | | | | | | | Slimline Indirect with external expansion | | | | | | | | |
|---|------|-----|-----|-----|-----|------|---|------|-----|-----|-----|-----|-----|-----|-------------|
| Size | H | D | I | T | IH1 | IH2 | Size | H | D | I | T | IH1 | CR1 | CF1 | Coil Rating |
| 100L | 1044 | 515 | 179 | 207 | 193 | 550 | 100L | 1044 | 515 | 179 | 207 | 193 | 209 | 320 | 14.6kW |
| 130L | 1326 | 515 | 179 | 207 | 193 | 643 | 130L | 1326 | 515 | 179 | 207 | 193 | 209 | 320 | 14.6kW |
| 150L | 1466 | 515 | 179 | 207 | 193 | 682 | 150L | 1466 | 515 | 179 | 207 | 193 | 209 | 320 | 14.6kW |
| 175L | 1738 | 515 | 179 | 207 | 193 | 832 | 175L | 1738 | 515 | 179 | 207 | 193 | 209 | 400 | 20.0kW |
| 210L | 2010 | 515 | 179 | 207 | 193 | 1008 | 210L | 2010 | 515 | 179 | 207 | 193 | 209 | 400 | 20.0kW |

Now available - Slimline Solar Indirect with external expansion

| Size | H | D | I | T | IH1 | CR1 | CF1 | CR2 | CF2 | Solar Coil Surface Area* | Aux Coil Surface Area* | Aux Coil Rating |
|------|------|-----|-----|-----|-----|-----|-----|-----|-----|--------------------------|------------------------|-----------------|
| 130L | 1326 | 515 | 179 | 207 | 504 | 209 | 245 | 554 | 245 | 0.75m ² | 0.54m ² | 14.6kW |
| 150L | 1466 | 515 | 179 | 207 | 504 | 209 | 245 | 554 | 245 | 0.75m ² | 0.54m ² | 14.6kW |
| 175L | 1738 | 515 | 179 | 207 | 609 | 209 | 350 | 659 | 315 | 1.1m ² | 0.75m ² | 20.0kW |
| 210L | 2010 | 515 | 179 | 207 | 609 | 209 | 350 | 659 | 315 | 1.1m ² | 0.75m ² | 20.0kW |

| Super-Slimline Direct with external expansion | | | | | | | Super-Slimline Indirect with external expansion | | | | | | | | |
|---|------|-----|-----|-----|-----|------|---|------|-----|-----|-----|-----|-----|-----|-------------|
| Size | H | D | I | T | IH1 | IH2 | Size | H | D | I | T | IH1 | CR1 | CF1 | Coil Rating |
| 80L | 1110 | 462 | 165 | 200 | 179 | - | 80L | 1110 | 462 | 165 | 200 | 179 | 195 | 320 | 14.6kW |
| 100L | 1344 | 462 | 165 | 200 | 179 | 664 | 100L | 1344 | 462 | 165 | 200 | 179 | 195 | 320 | 14.6kW |
| 130L | 1716 | 462 | 165 | 200 | 179 | 850 | 130L | 1716 | 462 | 165 | 200 | 179 | 195 | 320 | 14.6kW |
| 150L | 1935 | 462 | 165 | 200 | 179 | 1122 | 150L | 1935 | 462 | 165 | 200 | 179 | 195 | 320 | 14.6kW |
| 165L | 1998 | 462 | 165 | 200 | 179 | 1221 | 165L | 1998 | 462 | 165 | 200 | 179 | 195 | 400 | 20.0kW |

Excelsior WZ

Horizontal vessels



Horizontal Direct

| Size | A |
|------|------|
| 130L | 957 |
| 150L | 1085 |
| 175L | 1242 |
| 215L | 1484 |
| 255L | 1752 |
| 305L | 2028 |

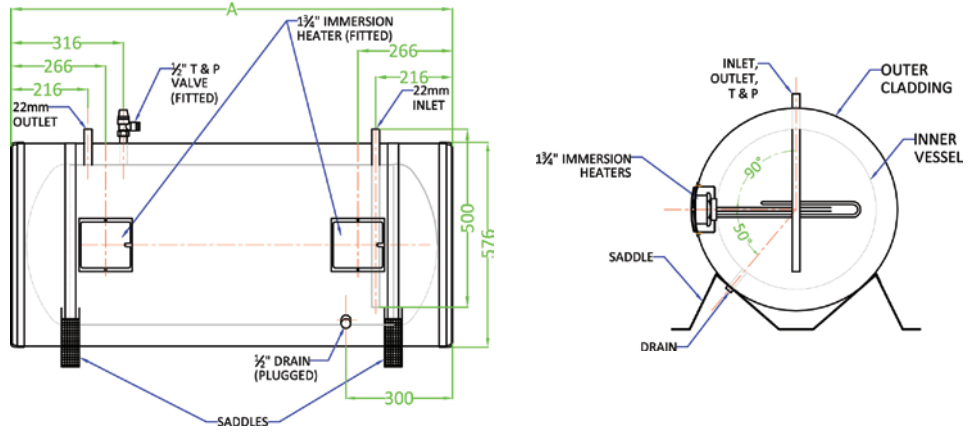

Horizontal Indirect

| Size | A | B | C | Aux Coil m ² |
|------|------|------|-----|-------------------------|
| 130L | 957 | 478 | 298 | 0.54 |
| 150L | 1085 | 543 | 363 | 0.54 |
| 175L | 1242 | 621 | 371 | 0.75 |
| 215L | 1484 | 742 | 492 | 0.75 |
| 255L | 1752 | 876 | 626 | 0.75 |
| 305L | 2028 | 1014 | 769 | 0.75 |

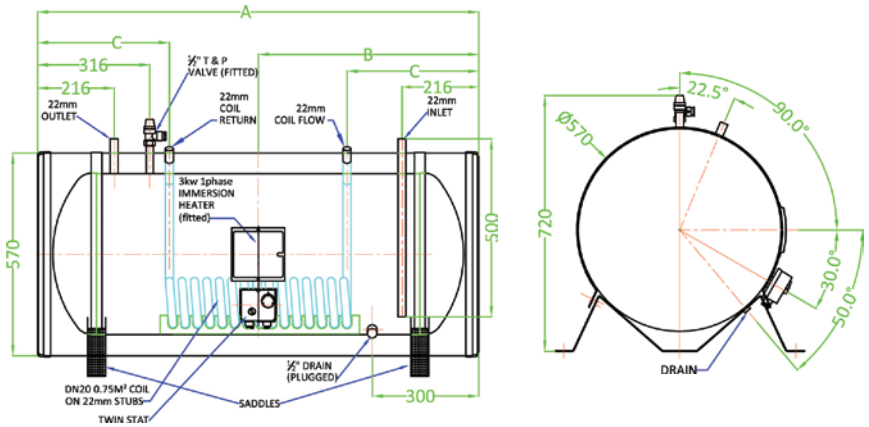

Excelsior WHP

Heat Pump range with external expansion

Heat Pump Single Coil

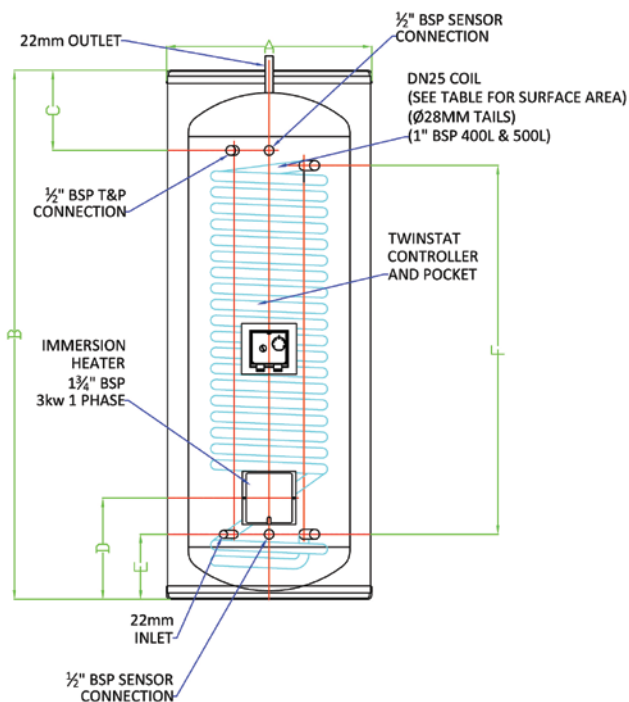

Heat Pump Twin Coil

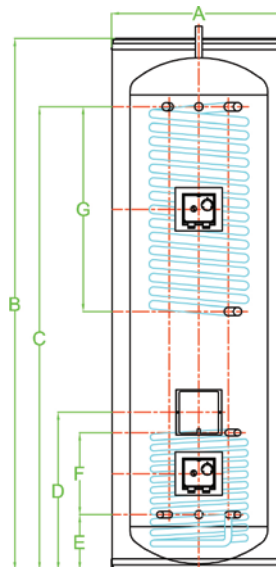

Heat Pump single coil with external expansion

| Size | A | B | C | D | E | F | HP Coil Surface Area* |
|------|-----|------|-----|-----|-----|------|-----------------------|
| 150L | 575 | 1085 | 225 | 284 | 182 | 678 | 2m ² |
| 175L | 575 | 1242 | 225 | 284 | 182 | 720 | 2m ² |
| 215L | 575 | 1485 | 225 | 284 | 182 | 1035 | 3m ² |
| 255L | 575 | 1752 | 225 | 284 | 182 | 1035 | 3m ² |
| 275L | 575 | 1884 | 225 | 284 | 182 | 1035 | 3m ² |
| 305L | 575 | 2028 | 225 | 284 | 182 | 1035 | 3m ² |
| 400L | 750 | 1405 | 262 | 303 | 228 | 495 | 4m ² |
| 500L | 750 | 1690 | 262 | 303 | 228 | 495 | 4m ² |

Heat Pump twin coil with external expansion

| Size | A | B | C | D | E | F | G | HP Coil Surface Area* | Solar Coil Surface Area |
|------|-----|------|------|-----|-----|-----|-----|-----------------------|-------------------------|
| 150L | 575 | 1085 | 856 | 355 | 182 | 105 | 385 | 1.5m ² | 0.54m ² |
| 175L | 575 | 1242 | 1013 | 460 | 182 | 210 | 525 | 1.5m ² | 0.75m ² |
| 215L | 575 | 1485 | 1259 | 520 | 182 | 270 | 675 | 2m ² | 1.1m ² |
| 255L | 575 | 1752 | 1527 | 520 | 182 | 270 | 675 | 2m ² | 1.1m ² |
| - | - | - | - | - | - | - | - | - | - |
| 305L | 575 | 2028 | 1800 | 520 | 182 | 270 | 675 | 2m ² | 1.1m ² |
| 400L | 750 | 1430 | 1196 | 655 | 276 | 315 | 480 | 3m ² | 2m ² |
| 500L | 750 | 1715 | 1481 | 655 | 276 | 315 | 720 | 4m ² | 2m ² |

Standard coil inlet and outlet diameter 28mm (DN25); Other coil sizes available upon request.

NEW - with 28mm inlet & outlet - single coil

| Size | A | B | C | D | E | F | HP Coil Surface Area* |
|------|-----|------|-----|-----|-----|-----|-----------------------|
| 400L | 750 | 1405 | 262 | 228 | 228 | 495 | 4m ² |
| 500L | 750 | 1690 | 262 | 228 | 228 | 495 | 4m ² |

NEW - with 28mm inlet & outlet - twin coil

| Size | A | B | C | D | E | F | G | HP Coil Surface Area* | Solar Coil Surface Area |
|------|-----|------|------|-----|-----|-----|-----|-----------------------|-------------------------|
| 400L | 750 | 1430 | 1196 | 655 | 276 | 315 | 480 | 3m ² | 2m ² |
| 500L | 750 | 1715 | 1481 | 655 | 276 | 315 | 720 | 4m ² | 2m ² |

Standard coil inlet and outlet diameter 28mm (DN25); Other coil sizes available upon request.

Also from Fabdec:

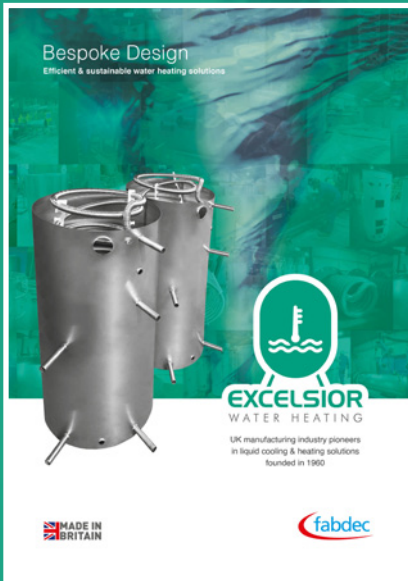

Bespoke Design

To learn more about the high performance and design values that an Excelsior vessel can offer, pick up one of our brochures.

Spares & Consumables

A comprehensive range of water heating spares including:

- ↳ Immersion heaters
- ↳ Valves - incl. T & P, pressure reducing, safety relief, non-return valves
- ↳ Expansion vessels
- ↳ Other accessories

www.fabdec.com/water-heating

Fabdec Ltd
Grange Road
Ellesmere
Shropshire
SY12 9DG

Tel: +44 (0) 1691 627200
Fax: +44 (0) 1691 627222
Email: sales@fabdec.com



Accreditation:



CIPHE
Industrial Associate

